

# Horizontal Carousel (HOCA)

Visit [www.constructor.no/en/Products/Storage-Machines-and-WMS/Horizontal-Carousel-HOCA/](http://www.constructor.no/en/Products/Storage-Machines-and-WMS/Horizontal-Carousel-HOCA/) for the latest information.

**Automatic Storage Machines are computer-controlled storage and transfer systems that significantly improve the efficiency of product storage and picking.**

These machines are easy to integrate with a Company's Warehouse Management System (WMS) but they can also be used as a standalone system. The site and operating environment determines the system's size and composition.

An automatic storage system can save up to 70% on floor space, reduce picking errors by 70% and decrease picking time by more than 60%. The most efficient way of using storage machines is to have article management included with the machine. TC2000 article management software is especially developed for Tornado, Paternoster and HOCA and it can be included as standard to all our machines.

Horizontal Carousel (HOCA) is a product in the category

## Storage Machines and WMS

Lift Systems (TORNADO)

Vertical Carousel (PATERNOSTER)

PaC-Light Update package

Horizontal Carousel (HOCA)

WMS & Control Software

Please visit [www.constructor.no](http://www.constructor.no) to see our other products.

## Description

Storage Machines & WMS › Horizontal Carousel (HOCA)

**Horizontal carousels are an excellent choice for large storage areas or where the building headroom is restricted. The horizontal storage system can accommodate large quantities of bulky goods, reducing picking times significantly.**

The system brings goods to an operator quickly and ergonomically. Productivity can be boosted even further by connecting several machines to a single retrieval point. This means that operator can pick from one carousel while other machines are rotating to be ready for the next pick.

Carousels can be equipped with pick-to-light systems that make batch-picking simple and fast for the operator.

## References

Grohe AG, Germany

Hospital Pharmacy Dresden, Germany



## Products

Provides optimal horizontal and vertical space utilization.

Dimensioning allows goods of different sizes to be stored in a single system.

One operator can use several machines

The system offers a safe way to store and handle materials.

Integration with the warehouse logistics environment and the company's WMS is easy.

The system offers rapid, easy picking. Picking time can be only 15 seconds / line.

The HOCA system is user-friendly and safe.

Batch picking provides great efficiency.

Restocking is easy to automate.

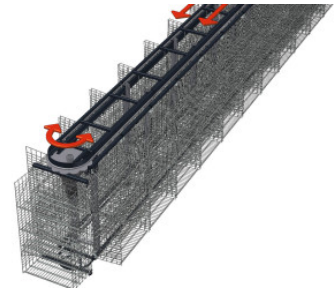
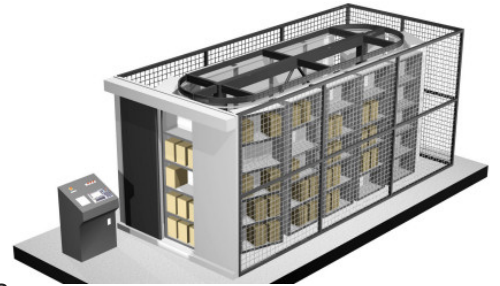

## Specifications

|                        |                   |
|------------------------|-------------------|
| Bay widths:            | 830 and 1010 mm   |
| Bay depths:            | 508 and 608 mm    |
| Bay heights:           | 1700-3900 mm      |
| Tray capacity:         | 100 kg            |
| Shelf division:        | 60 and 120 mm     |
| Bay capacity:          | 600 kg            |
| Total capacity:        | 40,000 kg maximum |
| Total widths:          | 1700 and 1900 mm  |
| Total length:          | 50 m Maximum      |
| Overall heights;       | 2150-4350 mm      |
| Electrical connection; | 230 VAC, 400 VAC  |
| Motor output;          | 1.5 kW, 2.2 kW    |

## Storage Machines & WMS › Horizontal Carousel (HOCA)



# Accessories - Horizontal Carousel (HOCA)

---

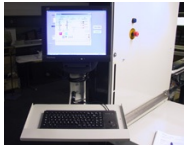

## Article Management Software TC2000

**TC2000** is a complete WMS designed for automatic storage and can be integrated into all Constructor machines.



## Plastic Storage Bin

Ideal for storing smaller items, available in a number of sizes. More info about [Plastic Bins](#)>>